

PCB Piezotronics Inc. claims proprietary rights in the information disclosed hereon. Neither it nor any reproduction thereof will be disclosed to others without the written consent of PCB Piezotronics Inc.

66526

REVISIONS		
REV	DESCRIPTION	DIN
A	UPDATED TITLE BLOCK	47696

4 MODEL 065A72 WATER TUBES (REPLACEABLE) 5/16-24 UNF-2A, AN TYPE FITTING

ELECTRICAL CONNECTOR COAXIAL 10-32 UNF-2A

2X Ø.05 [1.3] THRU SAFETY WIRE HOLE

O-RING (5-669)

6X Ø.05 [1.3] THRU SAFETY WIRE HOLES

2 1.125 [28.58] HEX

M14x1.25 - 6g

MOUNTING HOLE PREPARATION
M14x1.25-6H THRU
└┐ ⌀.625±.001 [15.88±.02] ▽.060 [1.52]

FLUSH MOUNT

RECESS MOUNT

MOUNTING HOLE PREPARATION
Ø.100 [2.54] THRU
M14x1.25-6H ▽.720 [18.29]
└┐ ⌀.625±.001 [15.88±.02] ▽.060 [1.52]

4 HELIUM INPUT, AN TYPE FITTING 5/16-24 UNF-2A

MODEL 006EB004EB ARMORED CABLE 4 ft [1.2 M] LONG

HELIUM FILTER (10 MICRON) 3

MODEL 065A15 SEAL (SUPPLIED)

PROTECTIVE CERAMIC COATING

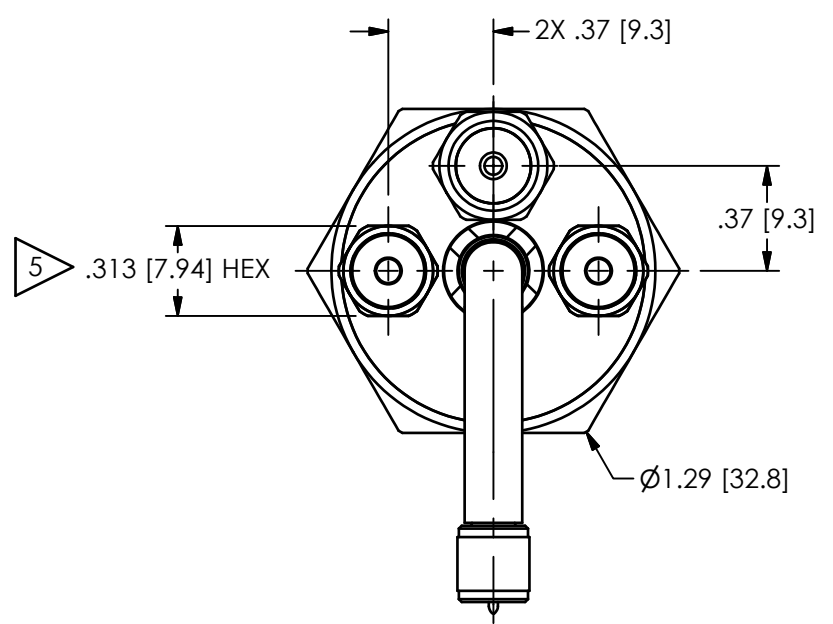

TOP VIEW

- 5 RECOMMENDED MOUNTING TORQUE ON .313 [7.94] HEX: 5-10 inch-lb [.56-1.13 Nm]
- 4 RECOMMENDED MOUNTING TORQUE: 15-30 inch-lb [1.7-3.4 Nm]
- 3 SUPPORT .375 [9.53] HEX ON FILTER WHEN ATTACHING LINE TO AVOID DAMAGE TO HELIUM INPUT TUBE
- 2 RECOMMENDED MOUNTING TORQUE ON 1.125 [28.58] HEX: 125±5 inch-lb [14±.5 Nm]
- 1 SEAL SURFACE MUST BE FLAT AND FREE OF TOOL MARKS WITH A 63 [1.5] FINISH

UNLESS OTHERWISE SPECIFIED TOLERANCES ARE:		DRAWN		CHECKED		ENGINEER	
DIMENSIONS IN INCHES	DIMENSIONS IN MILLIMETERS [IN BRACKETS]	KRM	1/15/18	KRM	1/15/18	DRK	1/15/18
DECIMALS XX ±.01 XXX ±.005	DECIMALS X ±.03 XX ±.013	TITLE INSTALLATION DRAWING SERIES 123B HELIUM BLEED WATER COOLED SENSOR					
ANGLES ± 2 DEGREES	ANGLES ± 2 DEGREES						
FILLETS AND RADII .003 - .005	FILLETS AND RADII 0.07 - 0.13	CODE IDENT. NO. 52681		DWG. NO. 66526		SCALE: 1.5X SHEET 1 OF 1	



3425 WALDEN AVE. DEPEW, NY 14043
(716) 684-0001 E-MAIL: sales@pcb.com