

2

1

PCB Piezotronics Inc. claims proprietary rights in the information disclosed hereon. Neither it nor any reproduction thereof will be disclosed to others without the written consent of PCB Piezotronics Inc.

REVISIONS

REV	DESCRIPTION	DIN
A	NOTE 3 WAS NOTE 4	44997

62262

B

B

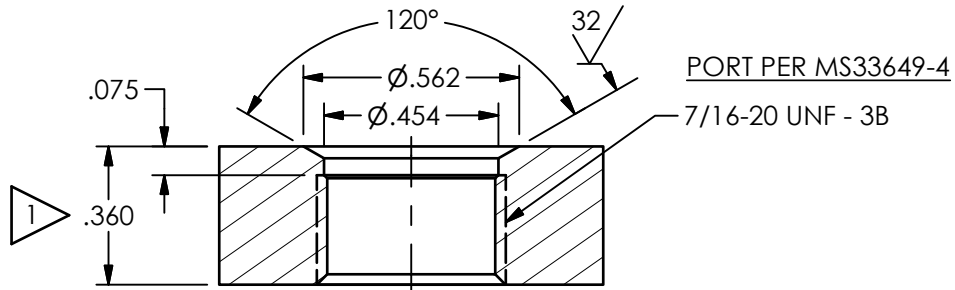
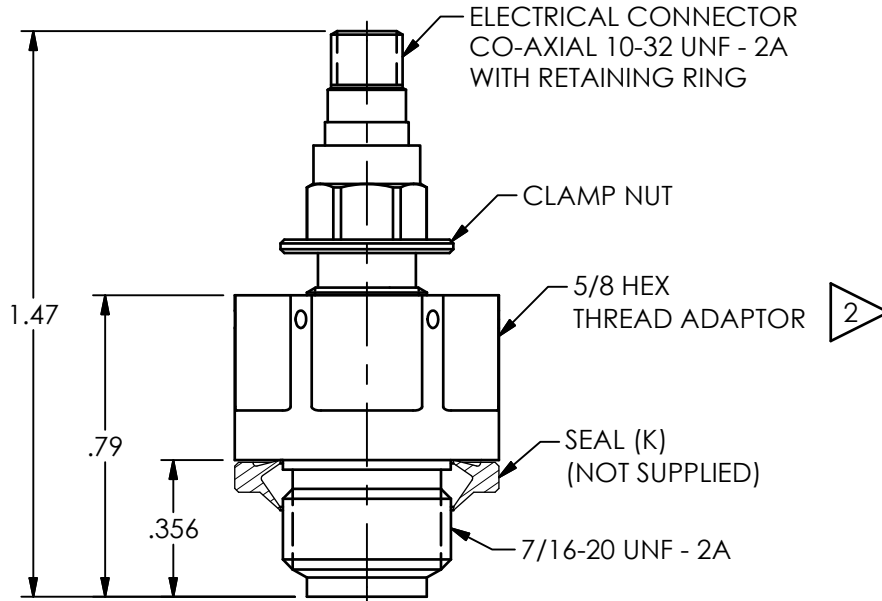
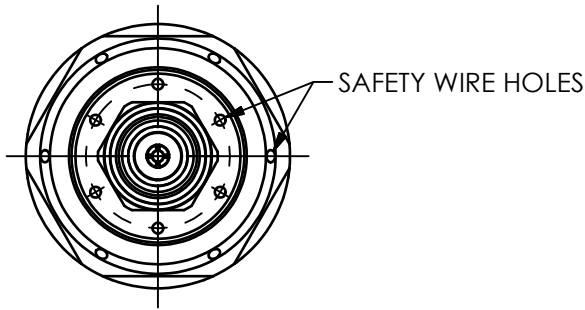

3.) THE ABOVE UNIT IS A SEALED ASSEMBLY AND SHOULD BE RETURNED TO THE FACTORY SHOULD SERVICE BE REQUIRED

2 MOUNTING TORQUE ON A 5/8 HEX: 120-130 IN-LBS

1 DIMENSIONS SHOWN ARE FOR .36 WALL THICKNESS, COUNTERBORE FOR THICKER WALLS

A

A

UNLESS OTHERWISE SPECIFIED TOLERANCES ARE:

DRAWN		CHECKED		ENGINEER	
JDM	2/15/16	AF	2/15/16	DRK	2/15/16



3425 WALDEN AVE. DEPEW, NY 14043  
(716) 684-0001 E-MAIL: sales@pcb.com

DIMENSIONS IN INCHES  
DECIMALS XX ±.01  
XXX ±.005  
ANGLES ± 2 DEGREES

DIMENSIONS IN MILLIMETERS  
[ IN BRACKETS ]  
DECIMALS X ± 0.3  
XX ± 0.13  
ANGLES ± 2 DEGREES

TITLE  
INSTALLATION DRAWING  
MODEL 102M295  
CRYOGENIC PRESSURE TRANSDUCER

CODE IDENT. NO. 52681  
DWG. NO. 62262

FILLETS AND RADII  
.003 - .005

FILLETS AND RADII  
0.07 - 0.13

SCALE: 2X SHEET 1 OF 1

2

1

1