

PCB Load & Torque Inc. claims proprietary rights in the information disclosed herein. Neither it nor any reproduction thereof will be disclosed to others without the written consent of PCB Load and Torque Inc.

REVISIONS		
REV	DESCRIPTION	ECO
B	ADDED STRAIN RELIEF LENGTH, CABLE LENGTH WAS 10 FT - 01.24.17, PTE	46057

46007

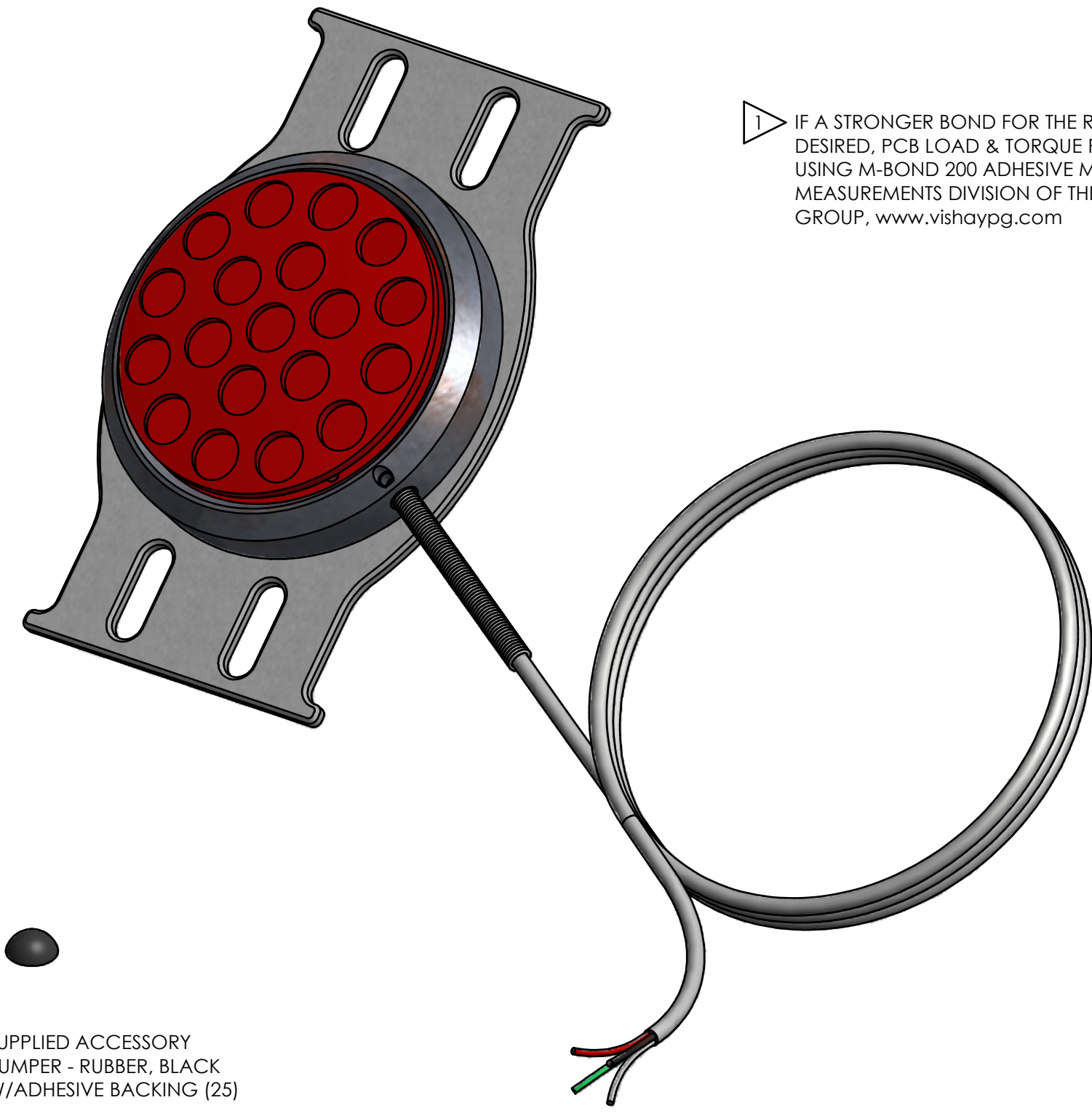
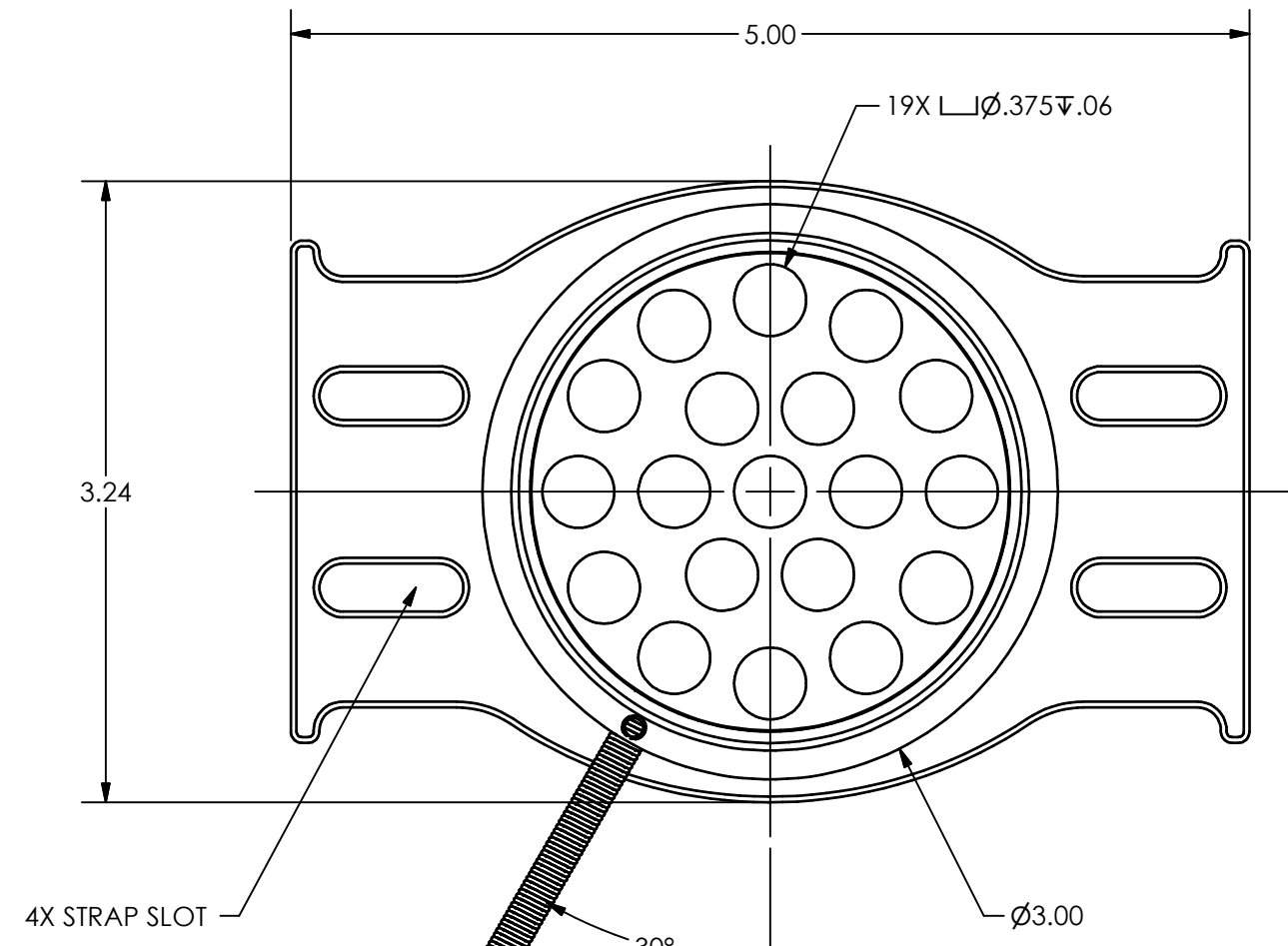

1 IF A STRONGER BOND FOR THE RUBBER BUMPERS IS DESIRED, PCB LOAD & TORQUE RECOMMENDS USING M-BOND 200 ADHESIVE MADE BY THE MICRO-MEASUREMENTS DIVISION OF THE VISHAY PRECISION GROUP. www.vishaypg.com

4 CONDUCTOR CABLE PIGTAIL ENDS, 11.5 FT LONG
RED (+EXC)
BLK (-EXC)
WHT (-SIG)
GRN (+SIG)

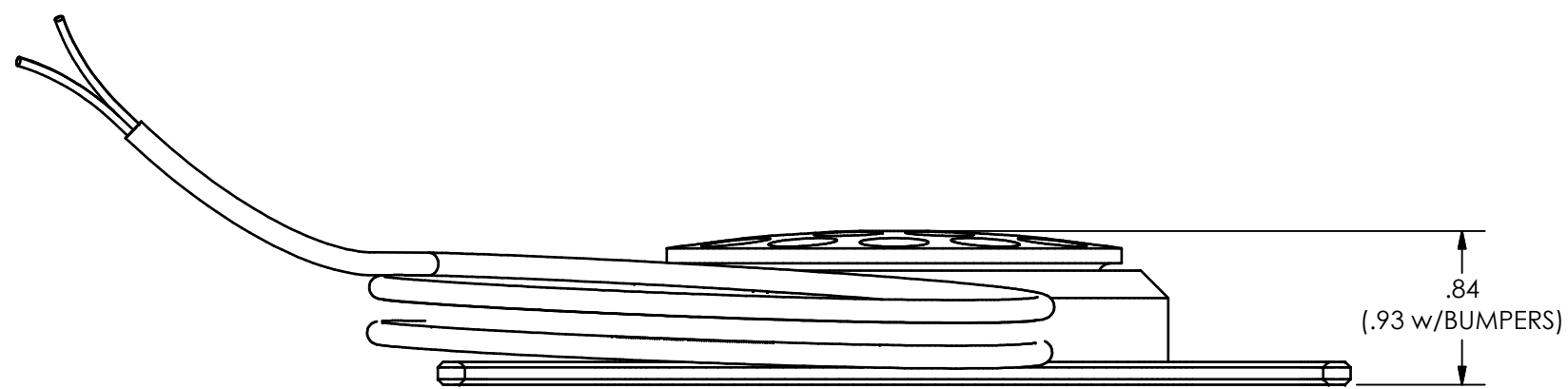
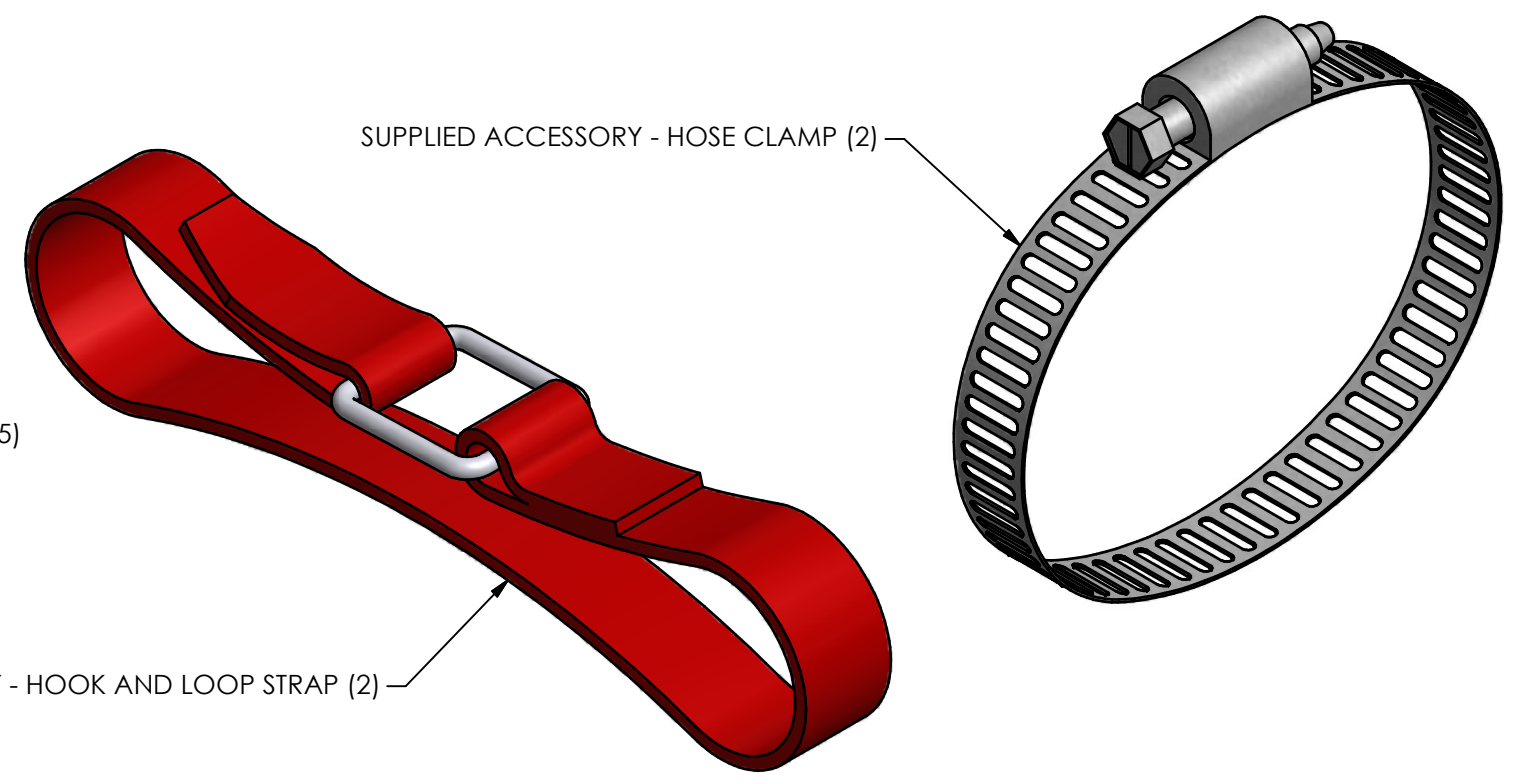
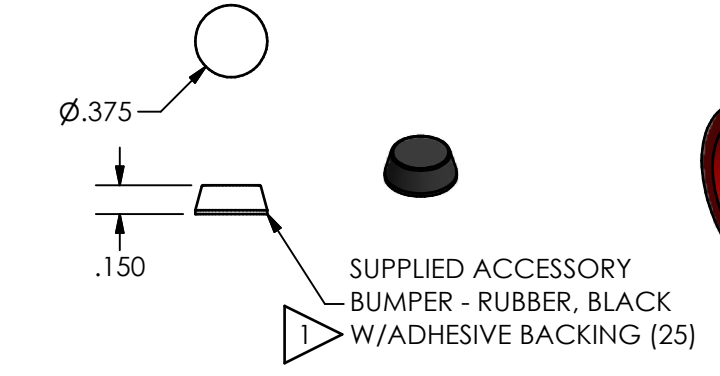
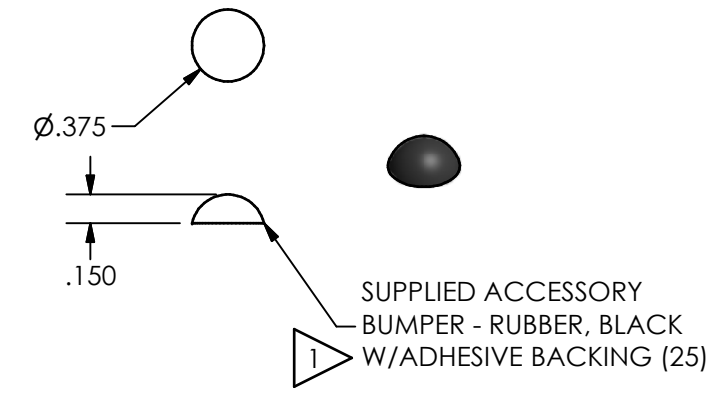
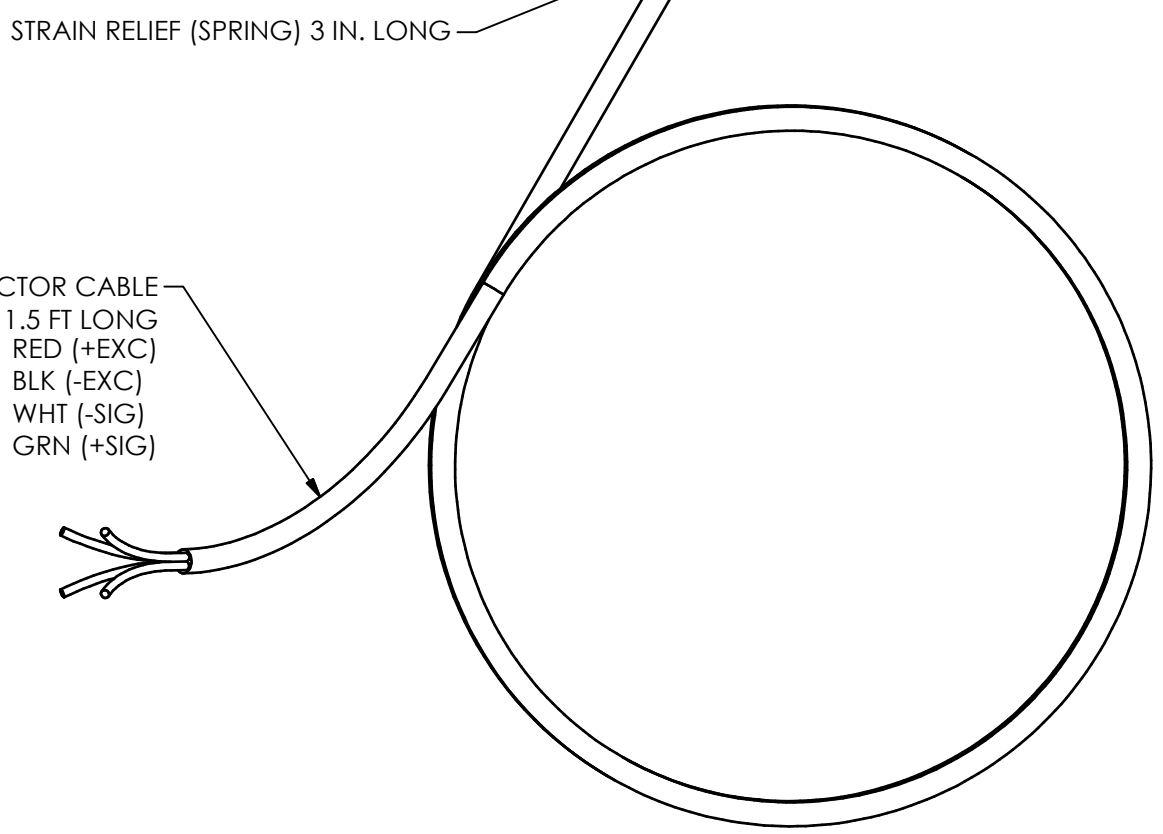

UNLESS OTHERWISE SPECIFIED TOLERANCES ARE:		DRAWN	CHECKED	ENGINEER	PCB LOAD & TORQUE A PCB GROUP COMPANY
DIMENSIONS IN INCHES	DIMENSIONS IN MILLIMETERS [IN BRACKETS]	JDM	ECB	PTE	
DECIMALS XX ± 0.01 XXX ± 0.005	DECIMALS X ± 0.3 XX ± 0.13	02.27.12	02.27.12	02.27.12	24350 Indoplex Circle, Farmington Hills, MI 48335 (716) 684-0001 E-MAIL: linfo@pcbloadtorque.com
ANGLES ± .5 DEGREES	ANGLES ± .5 DEGREES	TITLE			DWG. NO.
FILLETS AND RADII .015 MAX	FILLETS AND RADII 0.38 MAX	OUTLINE DRAWING PEDAL FORCE TRANSDUCER 300 & 500 LB CAP.			46007
		SCALE: FULL			SHEET 1 OF 1