

APPLICATION			REVISIONS				
NEXT ASS'Y	USED ON	VAR	REV	DESCRIPTION	ECN	DATE	APP'D
			C	O-RING REMOVED, SHRINK TUBING	15686	7/11/02	<i>DM</i>

10129

PCB Piezotronics Inc. claims proprietary rights in the information disclosed herein. Neither it nor any reproduction thereof will be disclosed to others without written consent of PCB Piezotronics Inc.

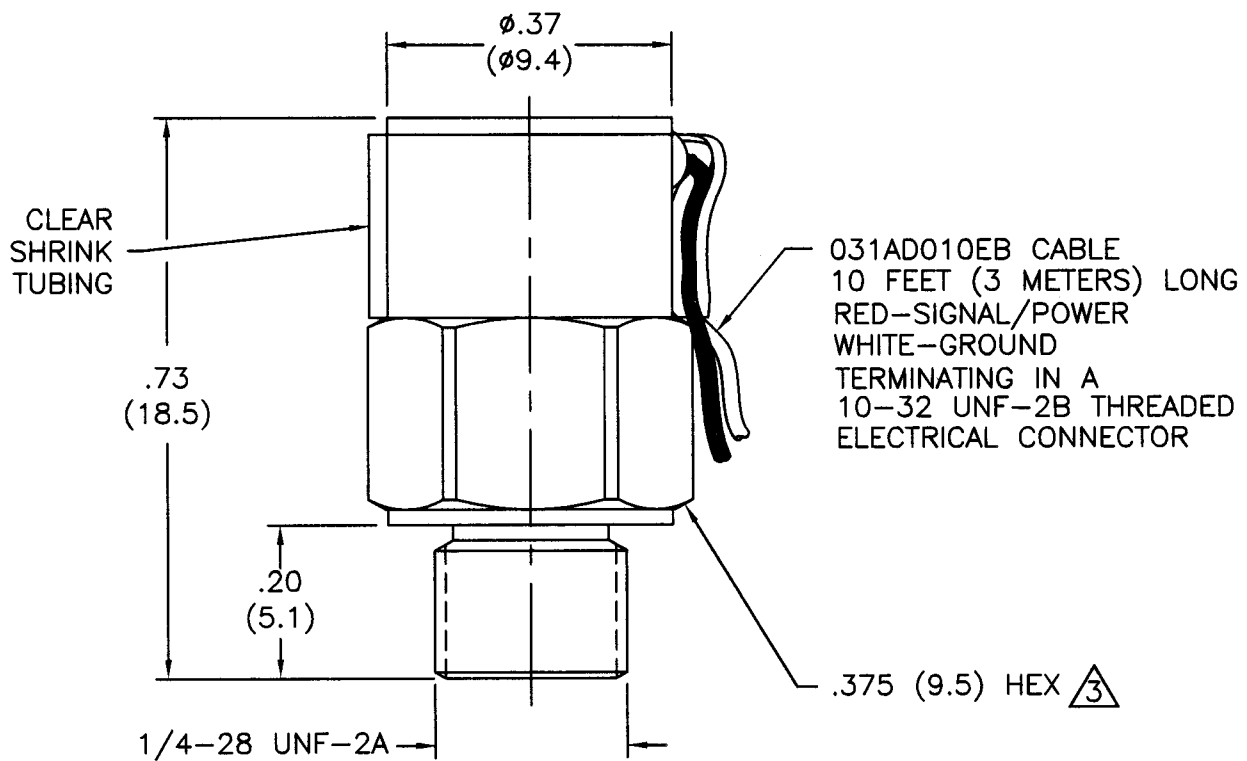

MOUNTING HOLE PREPARATION

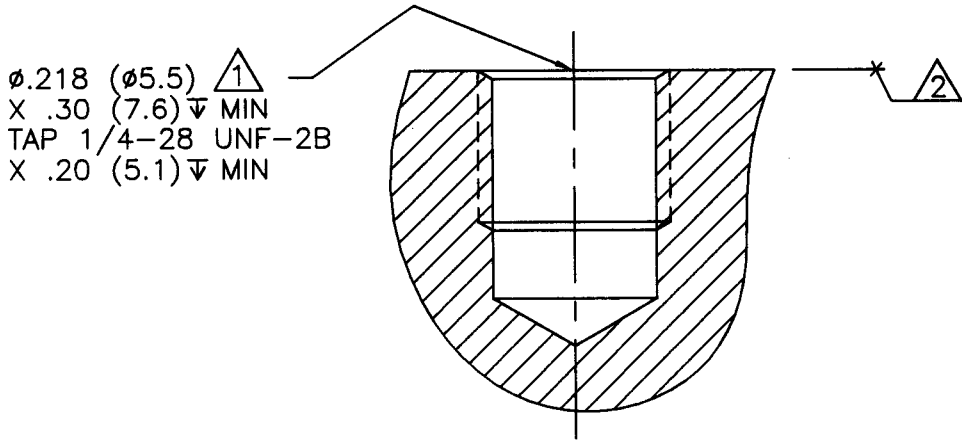

- 3 RECOMMENDED MOUNTING TORQUE ON .375 (9.5) HEX 2.5-4 FOOT POUNDS (2.8-3.4 NEWTON METERS).
- 2 MOUNTING SURFACE SHOULD BE FLAT TO WITHIN .001 (0.03) TIR OVER 0.375 (9.5) WITH A MINIMUM 63 (1.6) FINISH FOR BEST RESULTS.
- 1 DRILL PERPENDICULAR TO MOUNTING SURFACE TO WITHIN ±1°.

UNLESS SPECIFIED TOLERANCES		DRAWN	JDM	7-15-02	MFG	ky	7/15/02	 3425 WALDEN AVE. DEPEW, NY 14043 (716) 684-0001 EMAIL: SALES@PCB.COM
DIMENSIONS IN INCHES	DIMENSIONS IN MILLIMETERS (IN PARENTHESIS)	CHK'D	RSM	7/29/02	ENGR	APC	7/15/02	
DECIMALS XX ±.01	DECIMALS XX ±0.3	APP'D	<i>Plant</i>	8/12/02	SALES	WDL	8/12/02	CODE IDENT. NO. 52681
XXX ±.005	XXX ±0.13	TITLE INSTALLATION DRAWING MODEL 350B21 ACCELEROMETER						DWG. NO. 10129
ANGLES ±2 DEGREES	ANGLES ±2 DEGREES							SCALE: 4 X
FILLETS AND RADII .003 - .005	FILLETS AND RADII (0.07 - 0.13)							SHEET 1 OF 1
DD011 REV. B 03/13/98								